

# Joinery by Bears.



FEATURES INCLUDE:

- + Artisan Craftsmanship
- + Elegant Scalloped Skirting
- + Spacious Storage Solutions
- + Seamless Soft-Closing Mechanisms
- + Neutral Honey Oak Finish

A perfect blend of heritage detailing and modern functionality

## The Belle Scalloped Vanity



01. Precision-engineered



02. Detail sculpting



03. The Blanco Stone Top  
Slica-free



04. Exceptional quality hardware

All Joinery by Bears products come with exceptional quality hardware attachments that ensure your piece is a standout design. Selected carefully to ensure timeless yet functional design speaks through every element.



05. Soft Closure Mechanisms

Never without the finer details, all vanities come fitted with seamless gliders and soft close drawers that allow for that added element of quality and consideration.

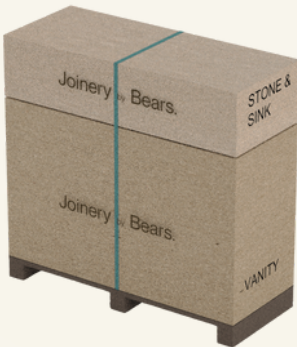

05. Secure & Durable Packaging  
for Nationwide Transport

## CABINET COLOUR:

- + Honey Oak
- + Customizable- any Dulux colour, price to be quote

## STONE COLOUR:

- + Carrara Marble
- + Blanco
- + Customizable- price to be quote

## BASIN:

- + White ceramic undermount
- + Allow 32 or 40mm waste (not included)

## HARDWARE:

- + Brass Gloss Gold handles
- + Blum runner & hinge

## INQUIRIES:

hello@joinerybybears.com

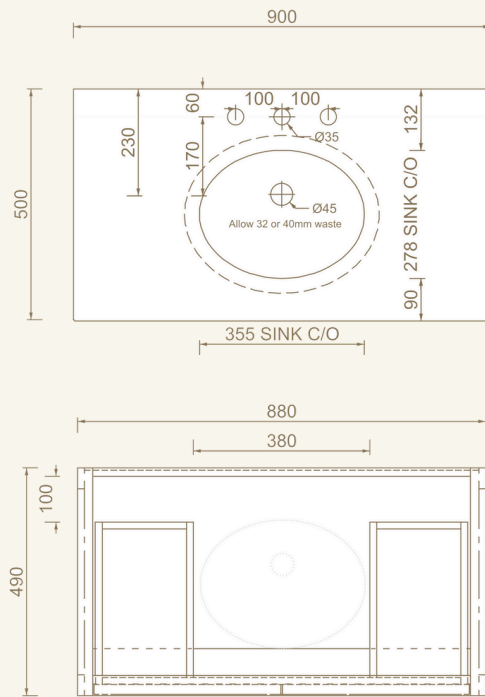

## The Belle Vanity 900

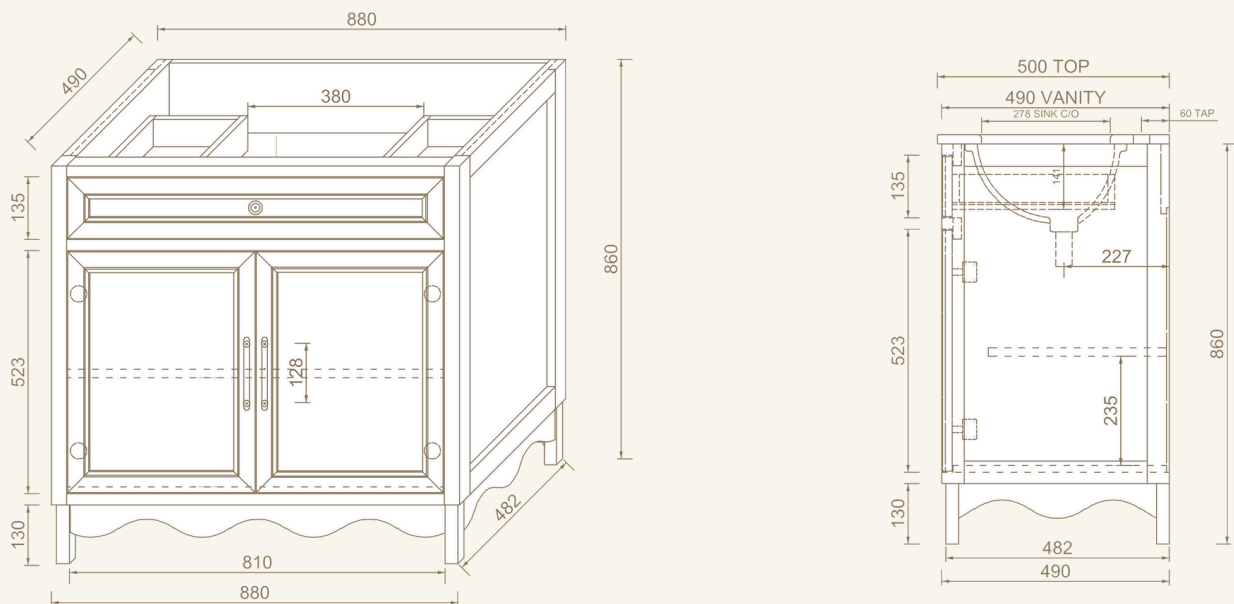

## CONSTRUCTION &amp; MATERIAL

- + Frame & Legs: Solid American Red Oak
- + Drawer Moldings: Solid American Red Oak
- + Drawer & Door Fronts: MDF
- + Vanity Body: Plywood
- + Finish: Three-layer protective coating with neutral honey oak varnish
- + Moisture Resistance: Yes

## STRUCTURE:

- 1 x cutout drawer
- 1 x double door

## INSTALLATION:

- + Freestanding, fully assembled vanity – no additional assembly required
- + Stone top pre-glued with basin – requires 1-2 people to lift and place
- + Silicone sealing recommended for top and side edges if necessary.
- + No tap hole unless requested for flexible faucet placement.

♥ For full installation details, please view:

[Freestanding Vanity Installation Guide](#)

## PACKAGE:

- + Vanity 43KG 980\*580\*940 mm
- + Stone 24KG 1000\*600\*350mm

## CABINET COLOUR:

- + Honey Oak
- + Customizable- any Dulux colour, price to be quote

## STONE COLOUR:

- + Carrara Marble
- + Blanco
- + Customizable- price to be quote

## BASIN:

- + White ceramic undermount
- + Allow 32 or 40mm waste (not included)

## HARDWARE:

- + Brass Gloss Gold handles
- + Blum runner & hinge

## INQUIRIES:

hello@joinerybears.com

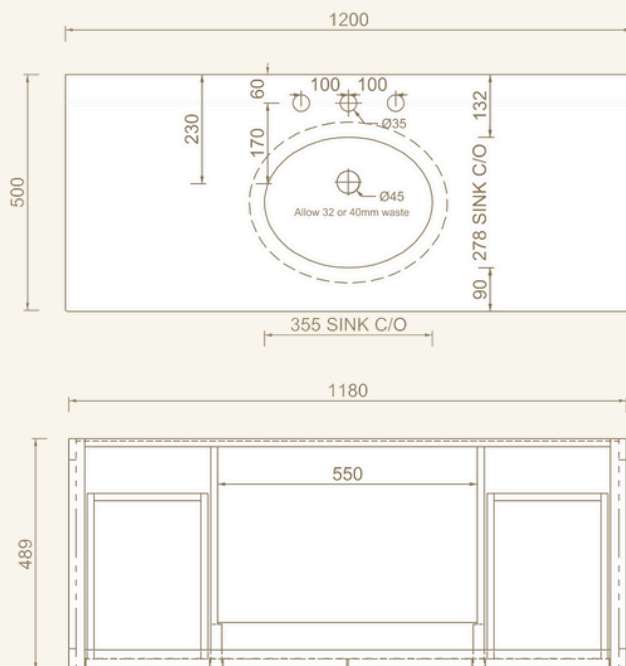

## The Belle Vanity 1200

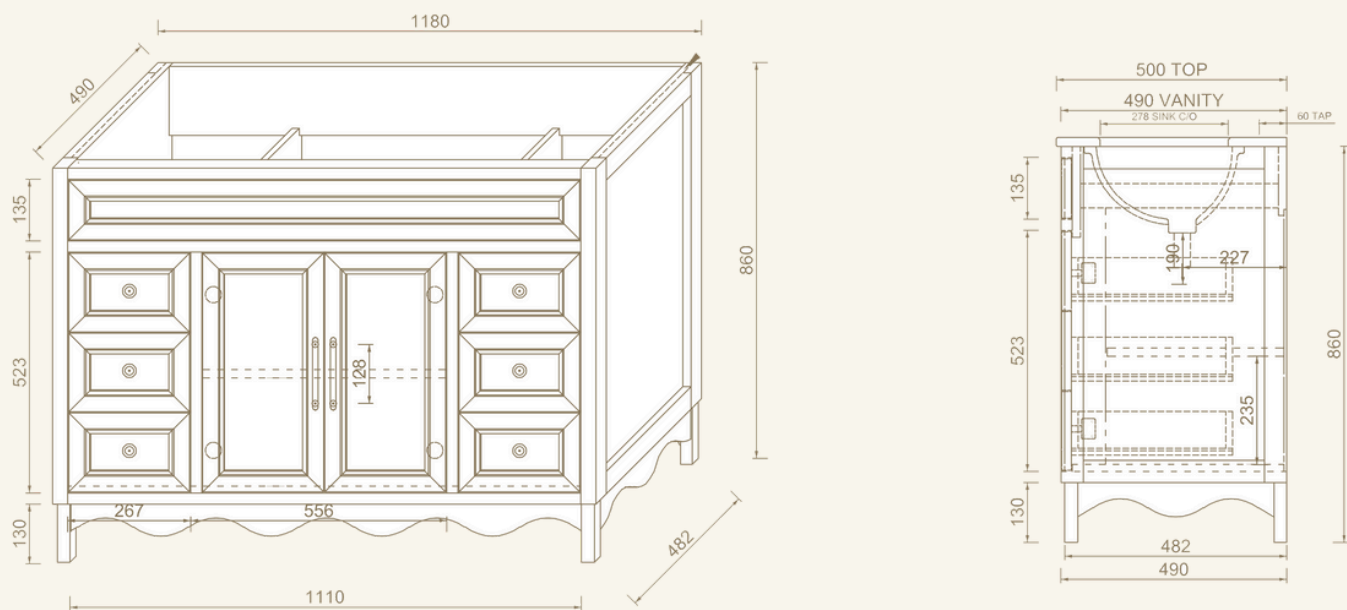

## CONSTRUCTION &amp; MATERIAL

- + Frame & Legs: Solid American Red Oak
- + Drawer Moldings: Solid American Red Oak
- + Drawer & Door Fronts: MDF
- + Vanity Body: Plywood
- + Finish: Three-layer protective coating with neutral honey oak varnish
- + Moisture Resistance: Yes

## STRUCTURE:

- 6 x drawers
- 1 x double door

## INSTALLATION:

- + Freestanding, fully assembled vanity – no additional assembly required
- + Stone top pre-glued with basin – requires 1-2 people to lift and place
- + Silicone sealing recommended for top and side edges if necessary.
- + No tap hole unless requested for flexible faucet placement.

♥ For full installation details, please view:

[Freestanding Vanity Installation Guide](#)

## PACKAGE:

- + Vanity 57KG 1280\*580\*940 mm
- + Stone 32KG 1300\*600\*350mm

CABINET COLOUR:

- + Honey Oak
- + Customizable- any Dulux colour, price to be quote

STONE COLOUR:

- + Carrara Marble
- + Blanco
- + Customizable- price to be quote

BASIN:

- + White ceramic undermount
- + Allow 32 or 40mm waste (not included)

HARDWARE:

- + Brass Gloss Gold handles
- + Blum runner & hinge

INQUIRIES:

hello@joinerybybears.com

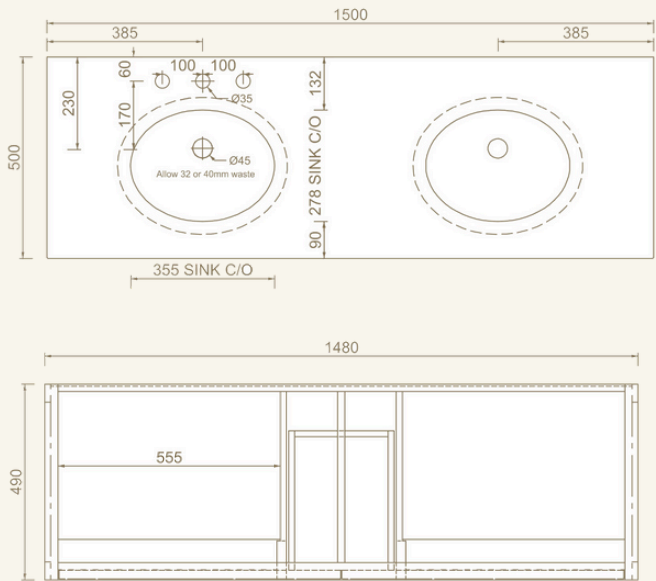

## The Belle Vanity 1500 Double

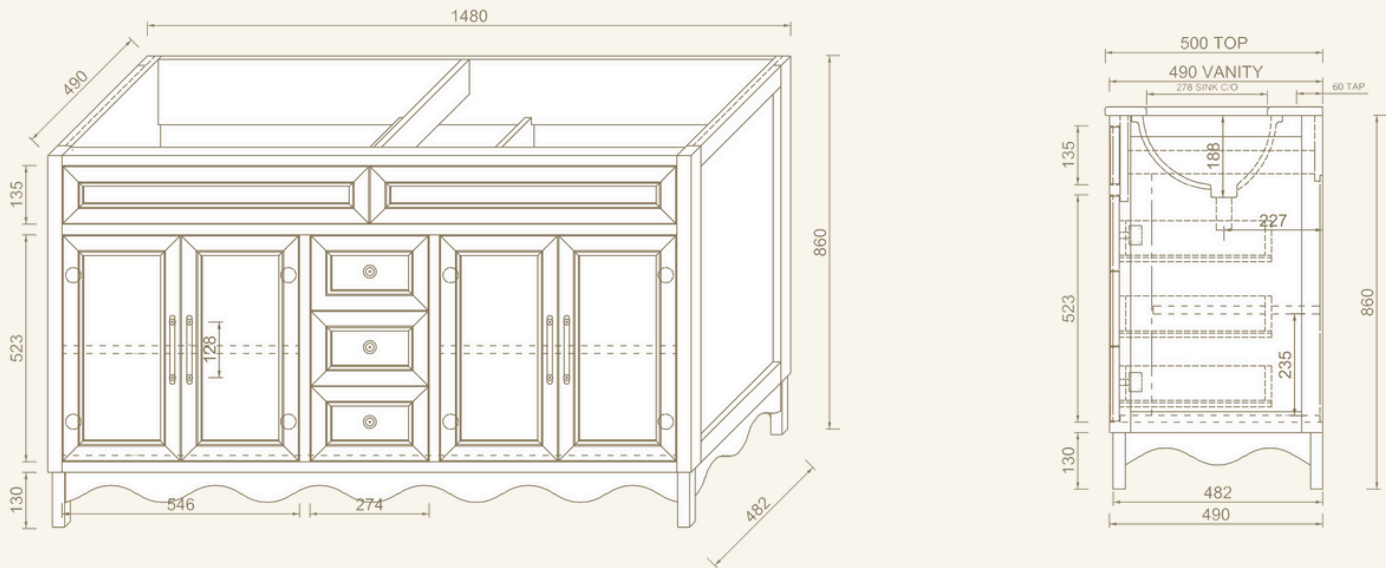

CONSTRUCTION & MATERIAL

- + Frame & Legs: Solid American Red Oak
- + Drawer Moldings: Solid American Red Oak
- + Drawer & Door Fronts: MDF
- + Vanity Body: Plywood
- + Finish: Three-layer protective coating with neutral honey oak varnish
- + Moisture Resistance: Yes

STRUCTURE:

- 3 x drawers
- 2 x double door

INSTALLATION:

- + Freestanding, fully assembled vanity – no additional assembly required
- + Stone top pre-glued with basin – requires 1-2 people to lift and place
- + Silicone sealing recommended for top and side edges if necessary.
- + No tap hole unless requested for flexible faucet placement.

♥ For full installation details, please view:

[Freestanding Vanity Installation Guide](#)

PACKAGE:

- + Vanity 73KG 1580\*580\*940 mm
- + Stone 43KG 1600\*600\*350mm

CABINET COLOUR:

- + Honey Oak
- + Customizable- any Dulux colour, price to be quote

STONE COLOUR:

- + Carrara Marble
- + Blanco
- + Customizable- price to be quote

BASIN:

- + White ceramic undermount
- + Allow 32 or 40mm waste (not included)

HARDWARE:

- + Brass Gloss Gold handles
- + Blum runner & hinge

INQUIRIES:

hello@joinerybybears.com

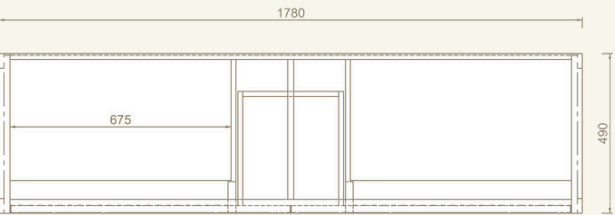
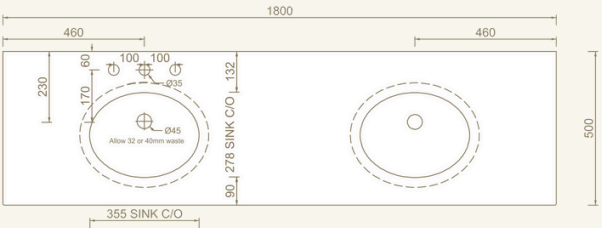

## The Belle Vanity 1800 Double

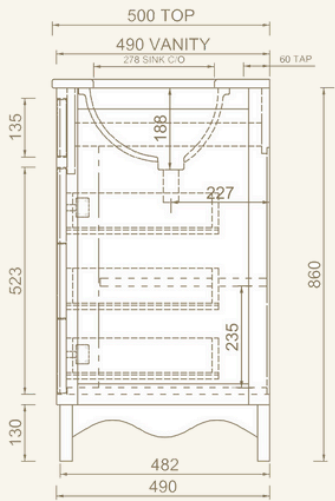
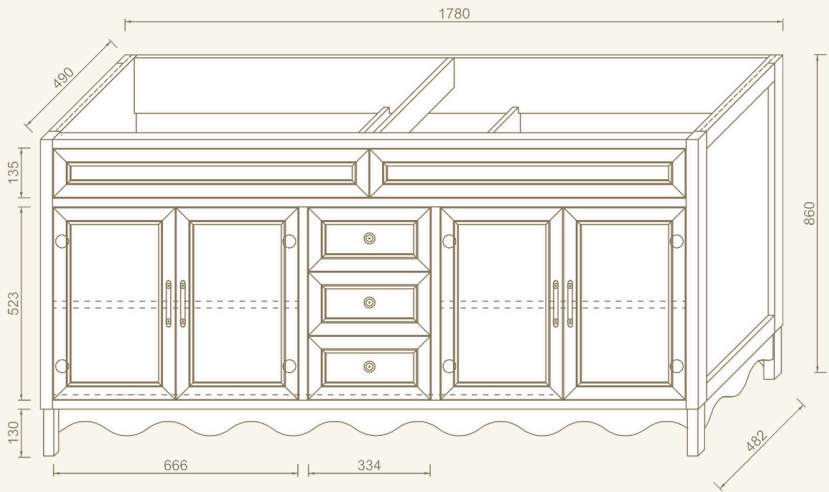

CONSTRUCTION & MATERIAL

- + Frame & Legs: Solid American Red Oak
- + Drawer Moldings: Solid American Red Oak
- + Drawer & Door Fronts: MDF
- + Vanity Body: Plywood
- + Finish: Three-layer protective coating with neutral honey oak varnish
- + Moisture Resistance: Yes

STRUCTURE:

- 3 x drawers
- 2 x double door

INSTALLATION:

- + Freestanding, fully assembled vanity – no additional assembly required
- + Stone top pre-glued with basin – requires 1-2 people to lift and place
- + Silicone sealing recommended for top and side edges if necessary.
- + No tap hole unless requested for flexible faucet placement.

♥ For full installation details, please view:

[Freestanding Vanity Installation Guide](#)

PACKAGE:

- + Vanity 110KG 1580\*580\*940 mm
- + Stone 85KG 1600\*600\*350mm

# Vanity Cabinet Cleaning Care Guide



Congratulations on your new vanity cabinet! To ensure its beauty and functionality last for years, please follow these care and cleaning instructions:

## Regular Cleaning:

### 1. Dusting:

- + Use a soft, dry cloth to dust the surface regularly.
- + Avoid using rough or abrasive cloths that may scratch the finish.

### 2. General Cleaning:

- + Wipe down the surface with a damp, soft cloth.
- + Use a mild soap or detergent if needed. Dilute the soap in water and apply with a cloth.
- + Immediately dry the surface with a clean, soft towel to prevent water spots and moisture damage.

## Deep Cleaning:

### 1. Stubborn Stains:

- + For tougher stains, use a mixture of water and a small amount of mild dish soap.
- + Apply the solution to the stain with a soft cloth, gently rubbing in a circular motion.
- + Rinse the area with a damp cloth and dry thoroughly.

### 2. Hardware Cleaning:

- + Use a damp cloth to wipe down handles and other hardware.
- + For brass handles, you may use a brass cleaner but ensure it doesn't come into contact with the cabinet surface.

## Specific Material Care:

### 1. Painted Surfaces:

- + Avoid harsh chemicals or abrasive cleaners that can damage the paint.
- + Use a mild, non-abrasive cleaner diluted with water.

### 2. Marble Countertop (if applicable):

- + Clean spills immediately to avoid staining.
- + Use a pH-neutral cleaner specifically designed for marble.
- + Avoid acidic or abrasive cleaners that can etch the surface.

## Preventative Care:

### 1. Avoid Excessive Moisture:

- + Do not allow water or other liquids to sit on the surface for extended periods.
- + Always wipe up spills immediately to prevent damage.

### 2. Heat Protection:

- + Avoid placing hot items directly on the vanity surface. Use trivets or heat pads to protect the finish.

### 3. Use Gentle Cleaners:

- + Avoid using bleach, ammonia, or other harsh chemicals.
- + Opt for mild, non-abrasive cleaners designed for the specific materials of your vanity.

## Maintenance Tips:

### 1. Regular Inspections:

- + Periodically check for any signs of damage or wear and address them promptly.
- + Tighten any loose hardware to maintain the integrity of the cabinet.

### 2. Protective Coating:

- + Consider applying a protective wax or sealant to the surface to enhance durability and shine.
- + Follow the manufacturer's instructions for any products used.

By following these care instructions, you can ensure that your vanity cabinet remains beautiful and functional for many years.

Thank you for choosing our product!

For any further questions or assistance, please contact our customer service team at:

- + Email: [hello@joinerybears.com](mailto:hello@joinerybears.com)
- + Phone: 0411 013 310

